



LEE BROOM



DECANTERLIGHT

ASSEMBLY

1. UNSCREW CABLE CLAMP TO WIDEN CORD ACCESS
2. PASS LOOSE END OF THE LIGHT FITTING CABLE THROUGH THE NECK OF THE DECANTER UNTILL SUPPORTED ON THE RUBBER CAP
3. THREAD CABLE THROUGH CEILING ROSE
4. ADJUST TO REQUIRED HEIGHT
5. TIGHTEN CABLE CLAMP
6. TERMINATE WIRES IN A SUITABLE JUNCTION BOX OR BESA BOX
7. FIT CEILING ROSE TO CEILING, CONCEALING JUNCTION/BESA BOX AND CORD GRIP (DIFFERENT MATERIALS REQUIRE DIFFERENT TYPES OF FITTING - ALWAYS CHOOSE SCREWS AND PLUGS THAT ARE APPROPRIATE FOR THE MATERIAL)
8. FIT BULB IN LAMP HOLDER (25W MAXIMUM)
9. THE CRYSTAL DECANTER SIT'S FREELY ON THE RUBBER CAP - ADJUSTMENT WILL BE REQUIRED IN ORDER TO LEVEL THE POSITION
10. TO CHANGE LIGHT BULB, PLEASE ENSURE YOU LEAVE ENOUGH WIRE WHEN HANGING THE DECANTERLIGHT SO THAT YOU CAN SLIDE THE DECANTER UP THE WIRE AND CHANGE THE BULB (CHANGING THE BULB REQUIRES TWO PEOPLE)

CONTENTS



1 X
DECANTER



1 X
PENDANT
FITTING



1 X
CEILING
ROSE



1 X
RUBBER
CAP

ATTENTION

- WE SUGGEST THAT THE DECANTERLIGHT SHOULD BE INSTALLED BY A QUALIFIED ELECTRICIAN
- ENSURE POWER SUPPLY IS DISCONNECTED PRIOR TO INSTALLATION
- THIS PRODUCT IS FOR INTERIOR USE ONLY AND SHOULD BE INSTALLED IN A DRY ENVIRONMENT
- WHEN SWITCHED ON, THE DECANTER MAY BECOME HOT



25 W
MAXIMUM
WATTAGE

THIS PRODUCT
MUST BE
EARTHED

220/240V
50-60HZ

E27
LAMP
HOLDER

CARE AND CLEANING

- ONLY ATTEMPT TO CLEAN WHEN THE DECANTERLIGHT IS SWITCHED OFF
- PLEASE ALLOW A SUITABLE COOLING PERIOD BEFORE ATTEMPTING TO CLEAN THE DECANTERLIGHT OR REPLACE THE BULB
- ONLY USE A NON-ABRASIVE, SOFT, DRY CLOTH WHEN CLEANING THE DECANTERLIGHT

1.



2/3.

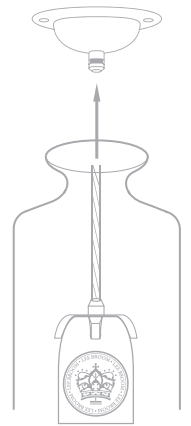

4/5.

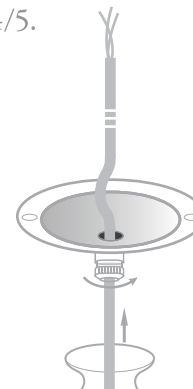

10.

